

MOSFET – Dual, N-Channel, Logic Level, POWER trench®

40 V, 12 A, 8.2 mΩ

FDMC9430L-F085

Features

- Typical $R_{DS(on)} = 6.3 \text{ m}\Omega$ at $V_{GS} = 10 \text{ V}$, $I_D = 12 \text{ A}$
- Typical $Q_{g(tot)} = 15 \text{ nC}$ at $V_{GS} = 10 \text{ V}$, $I_D = 12 \text{ A}$
- UIS Capability
- This Device is Pb-Free, Halide Free and RoHS Compliant
- AEC Qualified AEC-Q101

Applications

- Battery Protection
- Load Switching
- Point of Load

MAXIMUM RATINGS ($T_J = 25^\circ\text{C}$ unless otherwise noted)

Symbol	Parameter	Value	Unit
V_{DS}	Drain-to-Source Voltage	40	V
V_{GS}	Gate-to-Source Voltage	± 12	V
I_D	Drain Current – Continuous ($V_{GS} = 10$) (Note 1) $T_C = 25^\circ\text{C}$	12	A
	Pulsed Drain Current $T_C = 25^\circ\text{C}$	See Figure 4	
E_{AS}	Single Pulse Avalanche Energy (Note 2)	21.6	mJ
P_D	Power Dissipation	11.4	W
	Derate Above 25°C	0.1	W/ $^\circ\text{C}$
T_J, T_{stg}	Operating and Storage Temperature	-55 to $+150$	$^\circ\text{C}$
$R_{\theta JC}$	Thermal Resistance, Junction-to-Case	13	$^\circ\text{C/W}$
$R_{\theta JA}$	Maximum Thermal Resistance, Junction-to-Ambient (Note 3)	65	$^\circ\text{C/W}$

Stresses exceeding those listed in the Maximum Ratings table may damage the device. If any of these limits are exceeded, device functionality should not be assumed, damage may occur and reliability may be affected.

1. Current is limited by bondwire configuration.
2. Starting $T_J = 25^\circ\text{C}$, $L = 0.3 \text{ mH}$, $I_{AS} = 12 \text{ A}$, $V_{DD} = 40 \text{ V}$ during inductor charging and $V_{DD} = 0 \text{ V}$ during time in avalanche.
3. $R_{\theta JA}$ is the sum of the junction-to-case and case-to-ambient thermal resistance, where the case thermal reference is defined as the solder mounting surface of the drain pins. $R_{\theta JC}$ is guaranteed by design, while $R_{\theta JA}$ is determined by the board design. The maximum rating presented here is based on mounting on a 1 in^2 pad of 2 oz copper.

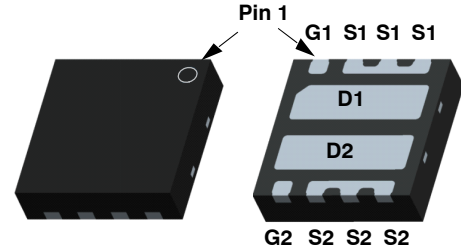

WDFN8
3x3, 0.65P
CASE 511DG

PIN ASSIGNMENT

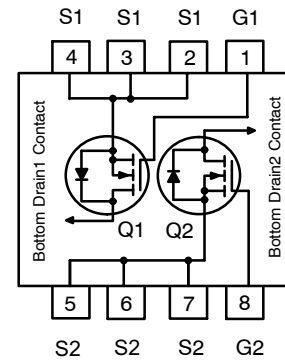

Dual N-Channel MOSFET

MARKING DIAGRAM

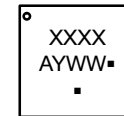

XXXX = Specific Device Code
A = Assembly Location
Y = Year
WW = Work Week
▪ = Pb-Free Package

(Note: Microdot may be in either location)

ORDERING INFORMATION

Device	Package	Shipping†
FDMC9430L-F085	WDFN8 (Pb-Free, Halide Free)	3000 Tape & Reel

†For information on tape and reel specifications, including part orientation and tape sizes, please refer to our Tape and Reel Packaging Specifications Brochure, BRD8011/D.

FDMC9430L–F085

ELECTRICAL CHARACTERISTICS (T_J = 25°C unless otherwise specified)

Symbol	Parameter	Test Condition	Min	Typ	Max	Unit
--------	-----------	----------------	-----	-----	-----	------

OFF CHARACTERISTICS

B _{VDS}	Drain-to-Source Breakdown Voltage	I _D = 250 μA, V _{GS} = 0 V	40	–	–	V
I _{DSS}	Drain-to-Source Leakage Current	V _{DS} = 40 V, V _{GS} = 0 V	–	–	1	μA
		T _J = 25°C	–	–	–	–
		T _J = 150°C (Note 4)	–	–	0.2	mA
I _{GSS}	Gate-to-Source Leakage Current	V _{GS} = ±12 V	–	–	±100	nA

ON CHARACTERISTICS

V _{GS(th)}	Gate-to-Source Threshold Voltage	V _{GS} = V _{DS} , I _D = 250 μA	1	1.8	3	V
R _{DS(on)}	Drain-to-Source On Resistance	I _D = 10 A, V _{GS} = 4.5 V	–	8.9	11.5	mΩ
		I _D = 12 A, V _{GS} = 10 V	–	6.3	8.0	–
		T _J = 25°C	–	–	–	–
		T _J = 150°C (Note 4)	–	10.2	13.0	–

DYNAMIC CHARACTERISTICS

C _{iss}	Input Capacitance	V _{DS} = 20 V, V _{GS} = 0 V, f = 1 MHz	–	984	–	pF
C _{oss}	Output Capacitance		–	315	–	–
C _{rss}	Reverse Transfer Capacitance		–	18	–	–
R _g	Gate Resistance	V _{GS} = 0.5 V, f = 1 MHz	–	1.1	–	Ω
Q _{g(ToT)}	Total Gate Charge	V _{GS} = 0 to 10 V	–	15	22	nC
Q _{g(th)}	Threshold Gate Charge	V _{GS} = 0 to 1 V	–	0.9	–	–
Q _{gs}	Gate-to-Source Gate Charge		–	2.6	–	–
Q _{gd}	Gate-to-Drain “Miller” Charge		–	2.1	–	–

SWITCHING CHARACTERISTICS

t _{on}	Turn-On Time	V _{DD} = 20 V, I _D = 12 A, V _{GS} = 10 V, R _{GEN} = 6 Ω	–	–	13	ns
t _{d(on)}	Turn-On Delay		–	7	–	–
t _r	Rise Time		–	2	–	–
t _{d(off)}	Turn-Off Delay		–	17	–	–
t _f	Fall Time		–	2	–	–
t _{off}	Turn-Off Time		–	–	28	–

DRAIN-SOURCE DIODE CHARACTERISTICS

V _{SD}	Source-to-Drain Diode Voltage	I _{SD} = 12 A, V _{GS} = 0 V	–	–	1.2	V
		I _{SD} = 6 A, V _{GS} = 0 V	–	–	1.1	–
t _{rr}	Reverse-Recovery Time	V _{DD} = 32 V, I _F = 12 A, dI _{SD} /dt = 100 A/μs	–	32	48	ns
Q _{rr}	Reverse-Recovery Charge		–	16	24	nC

Product parametric performance is indicated in the Electrical Characteristics for the listed test conditions, unless otherwise noted. Product performance may not be indicated by the Electrical Characteristics if operated under different conditions.

4. The maximum value is specified by design at T_J = 150°C. Product is not tested to this condition in production.

TYPICAL CHARACTERISTICS

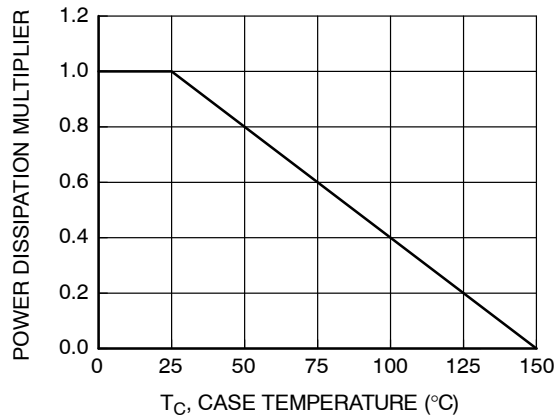

Figure 1. Normalized Power Dissipation vs. Case Temperature

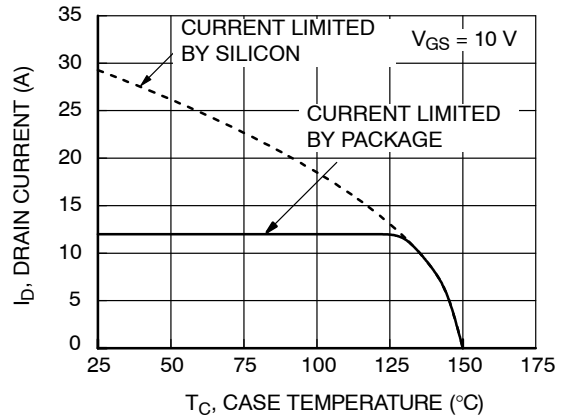

Figure 2. Maximum Continuous Drain Current vs. Case Temperature

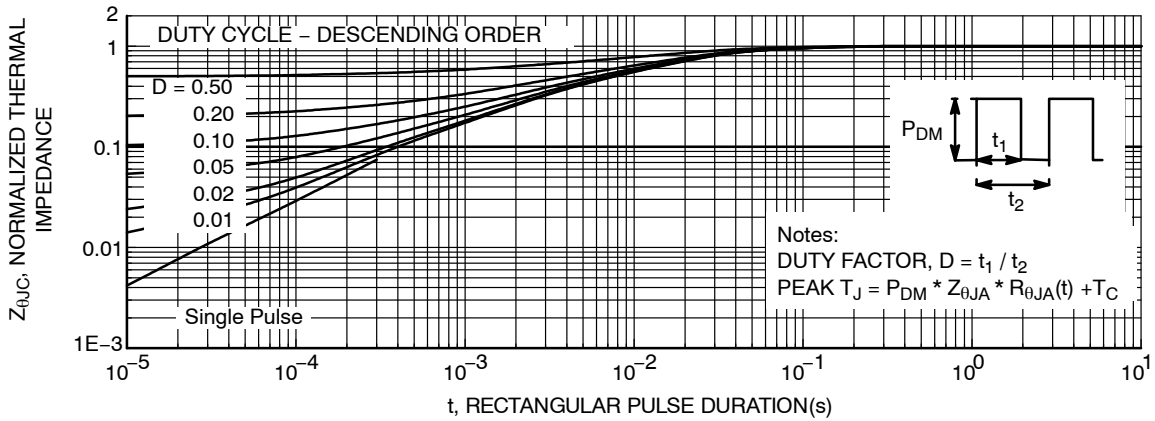

Figure 3. Normalized Maximum Transient Thermal Impedance

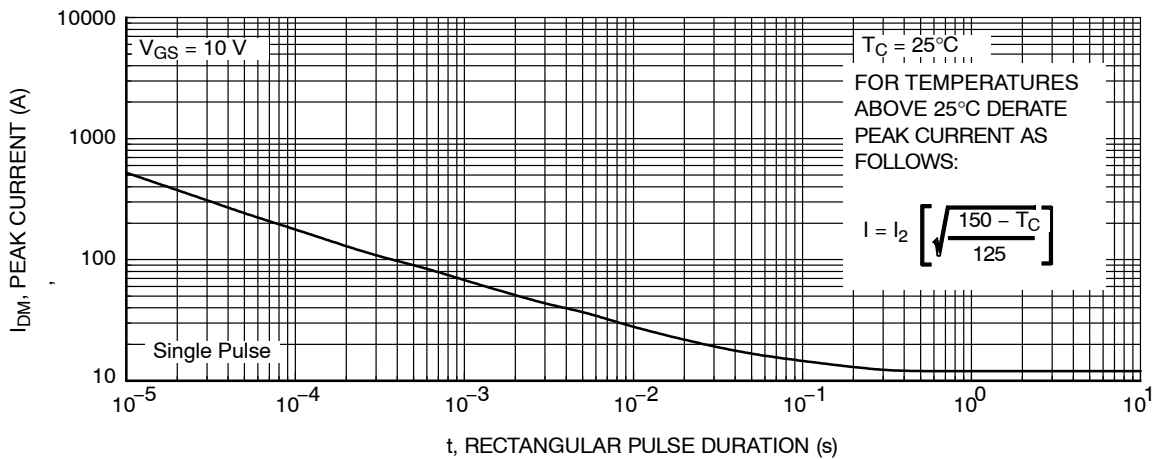

Figure 4. Peak Current Capability

TYPICAL CHARACTERISTICS

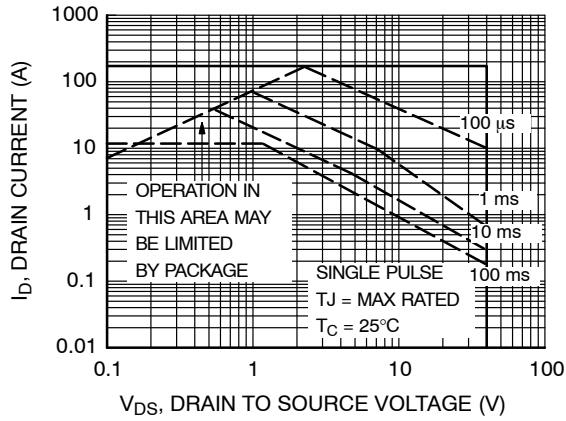
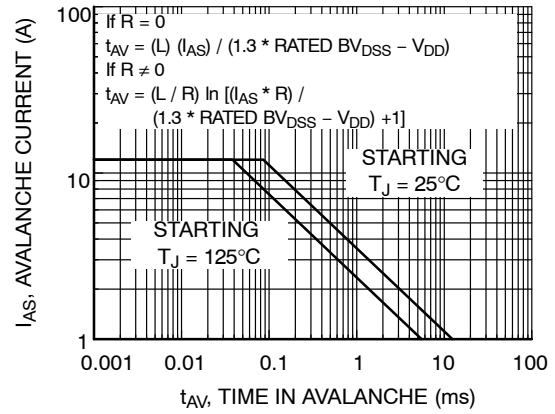

Figure 5. Forward Bias Safe Operating Area



NOTE: Refer to onsemi Application Notes AN7514 and AN7515

Figure 6. Unclamped Inductive Switching Capability

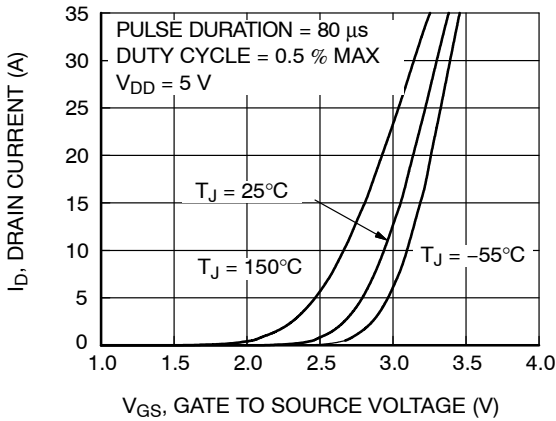

Figure 7. Transfer Characteristics

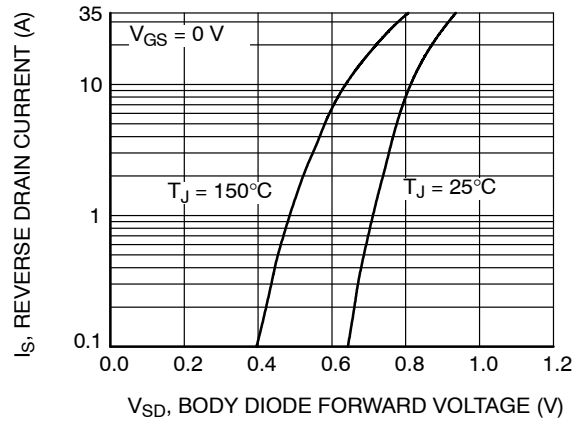

Figure 8. Forward Diode Characteristics

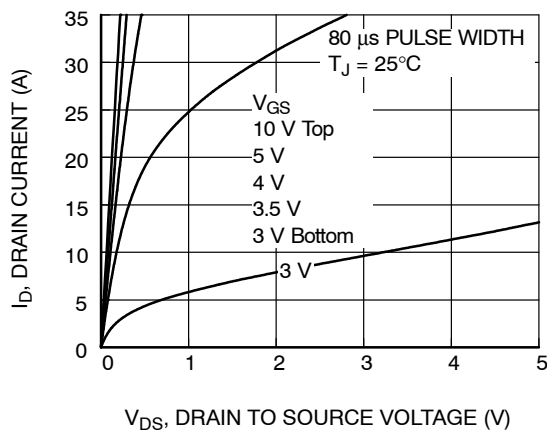

Figure 9. Saturation Characteristics

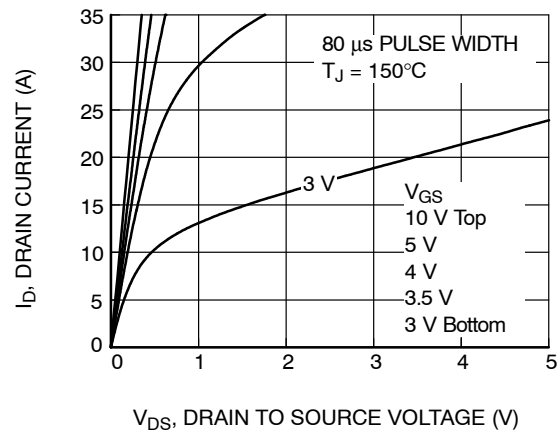

Figure 10. Saturation Characteristics

TYPICAL CHARACTERISTICS

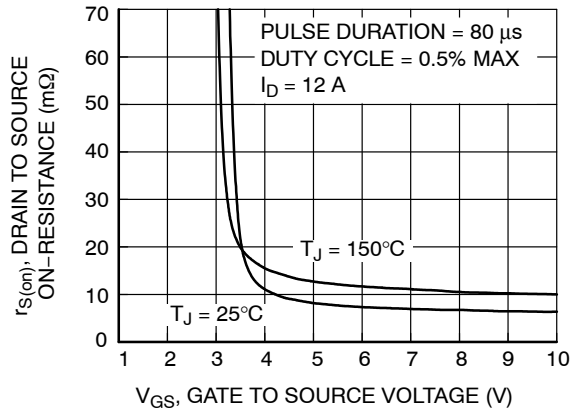

Figure 11. $R_{DS(on)}$ vs. Gate Voltage

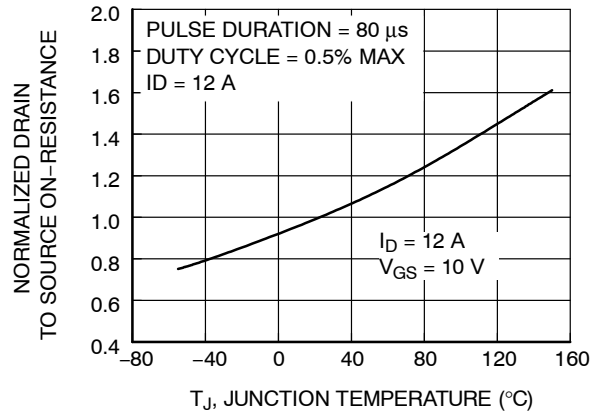

Figure 12. Normalized $R_{DS(on)}$ vs. Junction Temperature

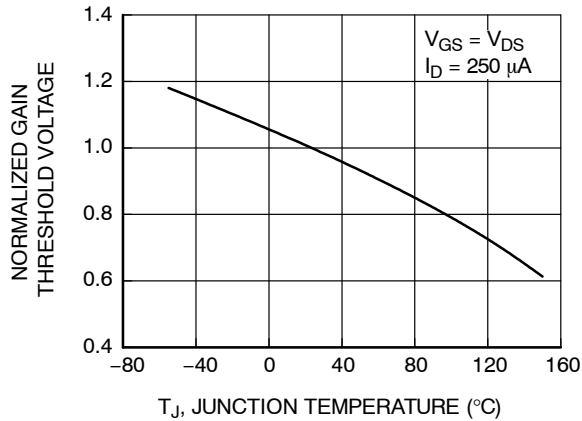

Figure 13. Normalized Gate Threshold Voltage vs. Temperature

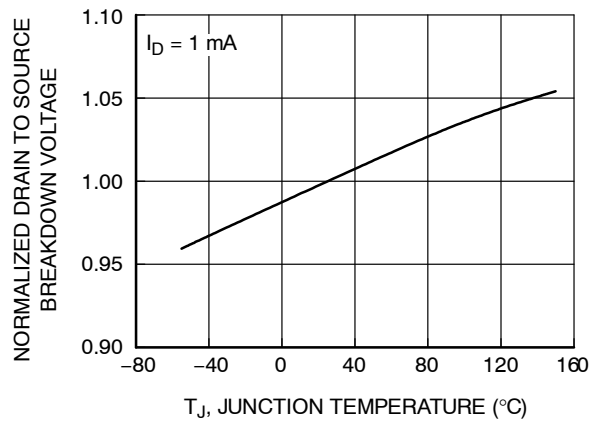

Figure 14. Normalized Drain-to-Source Breakdown Voltage vs. Junction Temperature

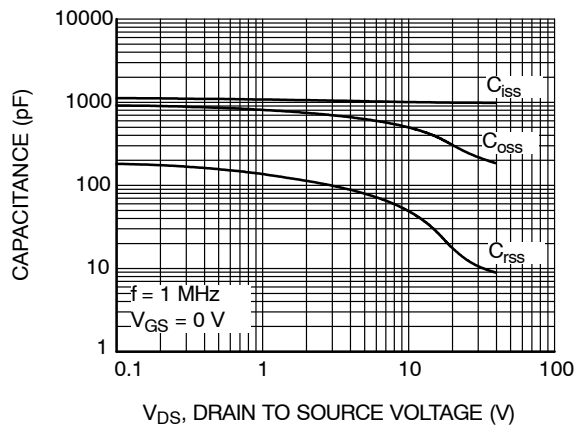

Figure 15. Capacitance vs. Drain-to-Source Voltage

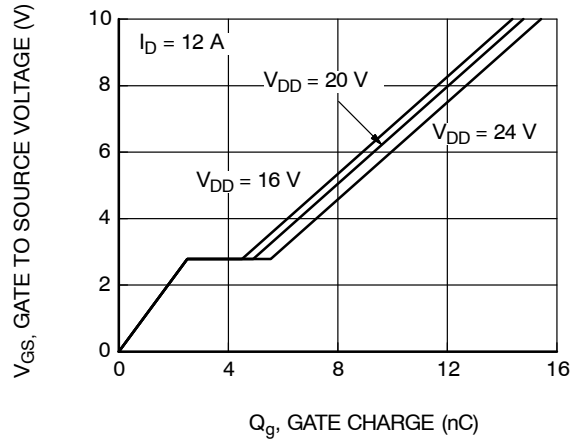
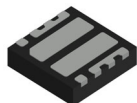
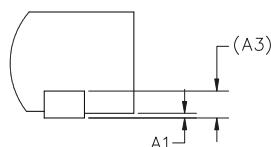
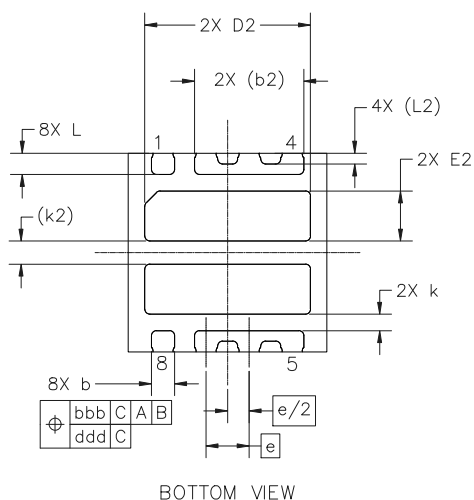
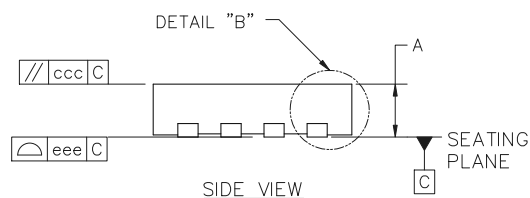
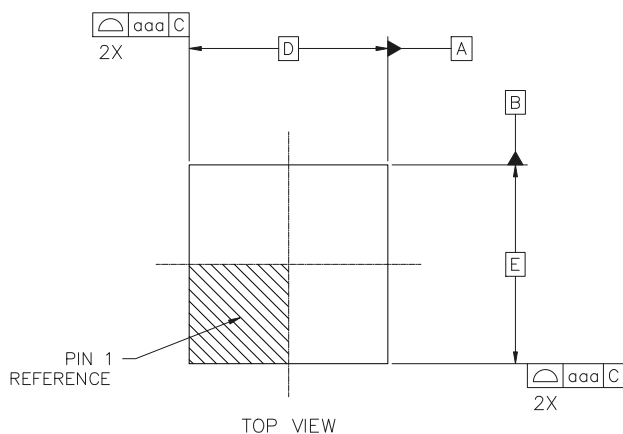

Figure 16. Gate Charge vs. Gate-to-Source Voltage



WDFN8 3.00x3.00x0.75, 0.65P
CASE 511DG
ISSUE B

DATE 15 NOV 2024



DETAIL "B"
SCALE 2:1

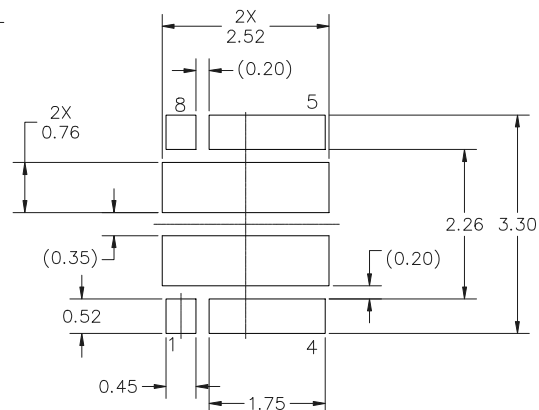

MILLIMETERS			
DIM	MIN	NOM	MAX
A	0.70	0.75	0.80
A1	0.00	---	0.05
A3	0.20 REF		
b	0.30	0.35	0.40
b2	1.65 REF		
D	3.00 BSC		
D2	2.45	2.50	2.55
E	3.00 BSC		
E2	0.71	0.76	0.81
e	0.65 BSC		
k	0.22	---	---
k2	0.35 REF		
L	0.27	0.32	0.37
L2	0.16 REF		
TOLERANCE FORM AND POSITION			
aaa	0.10		
bbb	0.10		
ccc	0.10		
ddd	0.05		
eee	0.08		

NOTES:

1. DIMENSIONING AND TOLERANCING AS PER ASME Y14.5M, 2018.
2. CONTROLLING DIMENSION: MILLIMETERS.
3. DIMENSION b APPLIES TO PLATED TERMINALS AND IS MEASURED BETWEEN 0.15 AND 0.30MM FROM THE TERMINAL TIP.
4. COPLANARITY APPLIES TO THE EXPOSED PAD AS WELL AS THE TERMINALS.

RECOMMENDED MOUNTING FOOTPRINT

- * For additional information on our Pb-Free strategy and soldering details, please download the onsemi Soldering and Mounting Techniques Reference Manual, [SOLDDRM/D](#).

DOCUMENT NUMBER:	98AON13623G	Electronic versions are uncontrolled except when accessed directly from the Document Repository. Printed versions are uncontrolled except when stamped "CONTROLLED COPY" in red.
DESCRIPTION:	WDFN8 3.00x3.00x0.75, 0.65P	PAGE 1 OF 1

onsemi and **onsemi** are trademarks of Semiconductor Components Industries, LLC dba **onsemi** or its subsidiaries in the United States and/or other countries. **onsemi** reserves the right to make changes without further notice to any products herein. **onsemi** makes no warranty, representation or guarantee regarding the suitability of its products for any particular purpose, nor does **onsemi** assume any liability arising out of the application or use of any product or circuit, and specifically disclaims any and all liability, including without limitation special, consequential or incidental damages. **onsemi** does not convey any license under its patent rights nor the rights of others.

onsemi, **Onsemi**, and other names, marks, and brands are registered and/or common law trademarks of Semiconductor Components Industries, LLC dba "**onsemi**" or its affiliates and/or subsidiaries in the United States and/or other countries. **onsemi** owns the rights to a number of patents, trademarks, copyrights, trade secrets, and other intellectual property. A listing of **onsemi**'s product/patent coverage may be accessed at www.onsemi.com/site/pdf/Patent-Marking.pdf. **onsemi** reserves the right to make changes at any time to any products or information herein, without notice. The information herein is provided "as-is" and **onsemi** makes no warranty, representation or guarantee regarding the accuracy of the information, product features, availability, functionality, or suitability of its products for any particular purpose, nor does **onsemi** assume any liability arising out of the application or use of any product or circuit, and specifically disclaims any and all liability, including without limitation special, consequential or incidental damages. Buyer is responsible for its products and applications using **onsemi** products, including compliance with all laws, regulations and safety requirements or standards, regardless of any support or applications information provided by **onsemi**. "Typical" parameters which may be provided in **onsemi** data sheets and/or specifications can and do vary in different applications and actual performance may vary over time. All operating parameters, including "Typicals" must be validated for each customer application by customer's technical experts. **onsemi** does not convey any license under any of its intellectual property rights nor the rights of others. **onsemi** products are not designed, intended, or authorized for use as a critical component in life support systems or any FDA Class 3 medical devices or medical devices with a same or similar classification in a foreign jurisdiction or any devices intended for implantation in the human body. Should Buyer purchase or use **onsemi** products for any such unintended or unauthorized application, Buyer shall indemnify and hold **onsemi** and its officers, employees, subsidiaries, affiliates, and distributors harmless against all claims, costs, damages, and expenses, and reasonable attorney fees arising out of, directly or indirectly, any claim of personal injury or death associated with such unintended or unauthorized use, even if such claim alleges that **onsemi** was negligent regarding the design or manufacture of the part. **onsemi** is an Equal Opportunity/Affirmative Action Employer. This literature is subject to all applicable copyright laws and is not for resale in any manner.

ADDITIONAL INFORMATION

TECHNICAL PUBLICATIONS:

Technical Library: www.onsemi.com/design/resources/technical-documentation
onsemi Website: www.onsemi.com

ONLINE SUPPORT: www.onsemi.com/support

For additional information, please contact your local Sales Representative at
www.onsemi.com/support/sales