

CPGA143 33x30
CASE 107FE
ISSUE O

DATE 23 JUN 2016

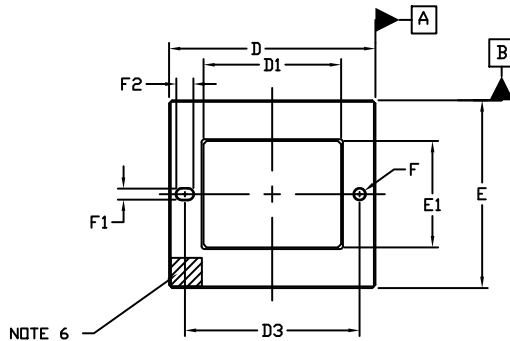

TOP VIEW

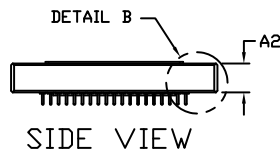

SIDE VIEW

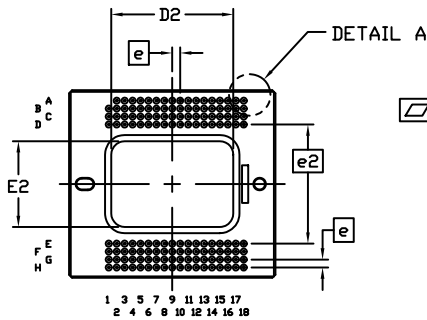

BOTTOM VIEW

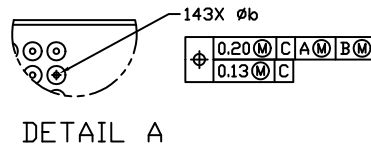

DETAIL A

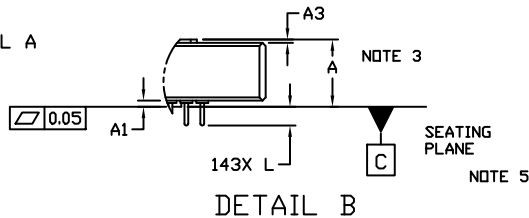

DETAIL B

NOTES:

1. DIMENSIONING AND TOLERANCING PER ASME Y14.5M, 1994.
2. CONTROLLING DIMENSION: MILLIMETERS
3. DIMENSION A INCLUDES THE PACKAGE BODY, GLASS, AND HEATSINK.
4. DIMENSIONS D AND E DO NOT INCLUDE PROTRUSIONS. SUCH PROTRUSIONS SHALL NOT EXTEND MORE THAN 0.08 ON ANY SIDE. CORNERS AND EDGES OF THE PACKAGE MAY HAVE CHAMFERS.
5. THE SEATING PLANE IS DEFINED BY THE OUTER HEATSINK SURFACE.
6. PIN A1 IDENTIFICATION WILL BE IN THIS AREA. ID TYPE MAY CONSIST OF NOTCHES, METALLIZED MARKINGS, OR OTHER FEATURES.

DIM	MILLIMETERS	
	MIN.	MAX.
A	---	6.38
A1	0.04	0.96
A2	4.15	5.07
A3	0.27	REF
b	0.17	0.43
D	32.97	33.33
D1	22.00	REF
D2	19.41	19.61
D3	27.66	28.22
E	29.87	30.13
E1	17.00	REF
E2	13.60	13.80
e	1.27	BSC
F	1.65	1.85
F1	1.65	1.85
F2	2.57	2.87
L	1.00	2.00

DOCUMENT NUMBER: 98AON12210G

Electronic versions are uncontrolled except when accessed directly from the Document Repository.
Printed versions are uncontrolled except when stamped "CONTROLLED COPY" in red.

DESCRIPTION: CPGA143 33X30

PAGE 1 OF 1

onsemi and onsemi are trademarks of Semiconductor Components Industries, LLC dba onsemi or its subsidiaries in the United States and/or other countries. onsemi reserves the right to make changes without further notice to any products herein. onsemi makes no warranty, representation or guarantee regarding the suitability of its products for any particular purpose, nor does onsemi assume any liability arising out of the application or use of any product or circuit, and specifically disclaims any and all liability, including without limitation special, consequential or incidental damages. onsemi does not convey any license under its patent rights nor the rights of others.